

Homefield KC

Multipurpose Fitness Center

Project: Homefield KC

Location: Kansas City, KS

Architect: Populous

Contractor: Turner Construction Company

Completion: April 2024

Scope: Homefield KC is a multipurpose venue designed to host national events in a cutting-edge space that prioritizes both functionality and style. Sightline Commercial Solutions was tapped to contribute a wide range of custom-engineered railing systems, totaling nearly 2,000 linear feet. Utilizing 3D laser scanning, we were able to capture precise dimensions of the entire building and create a model that allowed for swift completion of the many custom profiles, including picket rail, drink rail, aisle rail, separation rail and cane detection rail. Each railing style was finished in a sleek, black anodized aluminum, giving the facility a contemporary and uniform aesthetic. Sightline partnered closely with several collaborators to bring this facility to life. In tandem with Cardinal Glass, we helped incorporate the glass infill panels across seating areas, ensuring both safety and clear visibility throughout the venue's expansive court areas. We also coordinated installation of railing with 9/16" glass infill with a PVB interlayer along the front of the spectator bowl. Face mounting of the railing onto steel frames required careful alignment with the infill panels but, due to the combined experience of the Cardinal and Sightline team, we were able to finish on time and on budget. Additionally, we worked with Turner Construction to engineer drink rails that have the same countertop surfaces used throughout other areas in the building.



Sightline contributed a wide range of custom-engineered railing systems totaling nearly 2,000 linear feet.

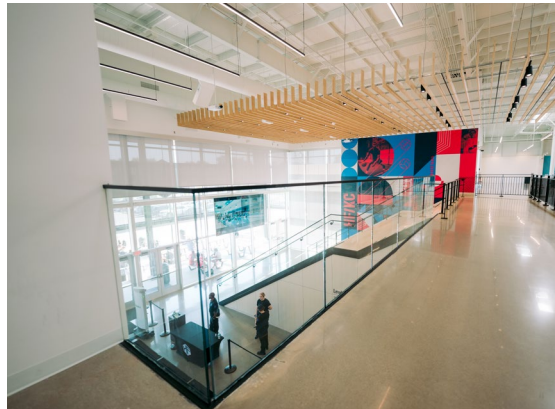

Custom designed glass railings line staircases.



We worked with Turner Construction to engineer drink rails that have the same countertop surfaces used throughout other areas in the building.



We coordinated installation of railing with 9/16" glass infill with a PVB interlayer along the front of the spectator bowl.



Glass infill panels across seating areas, ensuring both safety and clear visibility throughout the venue's expansive court areas.

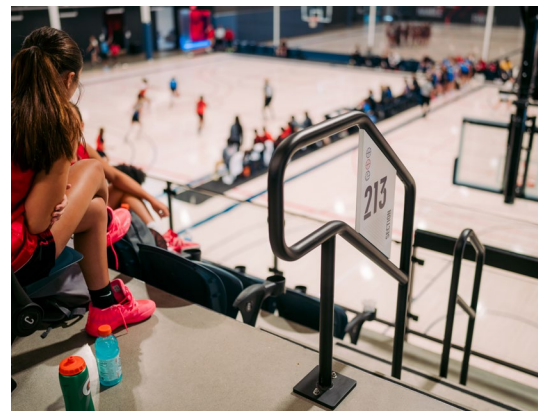

Each railing style was finished in a sleek, black anodized aluminum, giving the facility a contemporary and uniform aesthetic.

We elevate places where experiences happen by providing innovative engineering, fabrication, and installation solutions to the most complex challenges. Discover our unconventional approach.